

OPTIONAL



 MG860	 TRC01 GPS LOCALIZER	 EFR01
 MG850 MG850 S	 TRC01 GPS LOCALIZER	 EFR01
 MG845	 TRC01 GPS LOCALIZER	NOT AVAILABLE
 MG840	 TRC01 GPS LOCALIZER	NOT AVAILABLE
 RIF030	 TRC01 GPS LOCALIZER	NOT AVAILABLE



GPS LOCALIZER (TRC01), it can be installed in all vehicles.

It can be connected directly to the vehicle batteries or to the vehicle cigarette lighter, (it would be better to connect it directly to the vehicle batteries and to place it within the dashboard or in a hidden place).

When adding an ANTITAMPER BOARD to the MG850, the GPS LOCALIZER will detect the shocks and will send out a personalized SMS with the GPS position of the vehicle.



A Bluetooth system combined with the proximity key called "DISEC ID" grants recognition for the car-authorized user when he is near the vehicle. When he leaves, automatically the protection system is activated, without his manual intervention.



Inside the GSM Module, there must be a SIM CARD.



Two relays and 5 additional auxiliary lines grants permission to hard wire the GPS LOCALIZER; the alarm can be combined to the relays and used to turn OFF or turn ON different devices inside the vehicle, for ex. lights or alerting devices.

MAGNETIC LOCK



OPTIONAL



AVAILABLE ON ALL MODELS

ALL ELECTRONIC DEVICES ARE ACTIVATED OR DEACTIVATED AUTOMATICALLY WITH A SPECIAL DISEC ID PROXIMITY DEVICE



Available on MG850 / MG850 S
Available if connected to a GPS LOCALIZER
not available as a self-standing apparatus





MG850 / MG850 S



MG860



MG845



MG840



RIF030

- Easy fitting, no needs for special templates
- Key Alike System available on demand Master Key System available on demand for one master and two slave keys
- Anti-picking magnetic operated lock
- Cut resistant tungsten carbide bar
- Indoor opening cord

OPTIONAL

GPS LOCALIZER

ANTITAMPER ALARM
Available if connected to a GPS LOCALIZER

OPTIONAL

GPS LOCALIZER

- Easy fitting, "hook bar" no needs for special templates
- Key Alike System available on demand Master Key System available on demand for one master and two slave keys
- Anti-picking magnetic operated lock
- Stainless steel cover

OPTIONAL

GPS LOCALIZER

- Easy fitting "cross bar" magnetic system
- Key Alike System available on demand Master Key System available on demand for one master and two slave keys
- Anti-picking magnetic operated lock

OPTIONAL

GPS LOCALIZER

OPENING-CLOSING POSITIONS

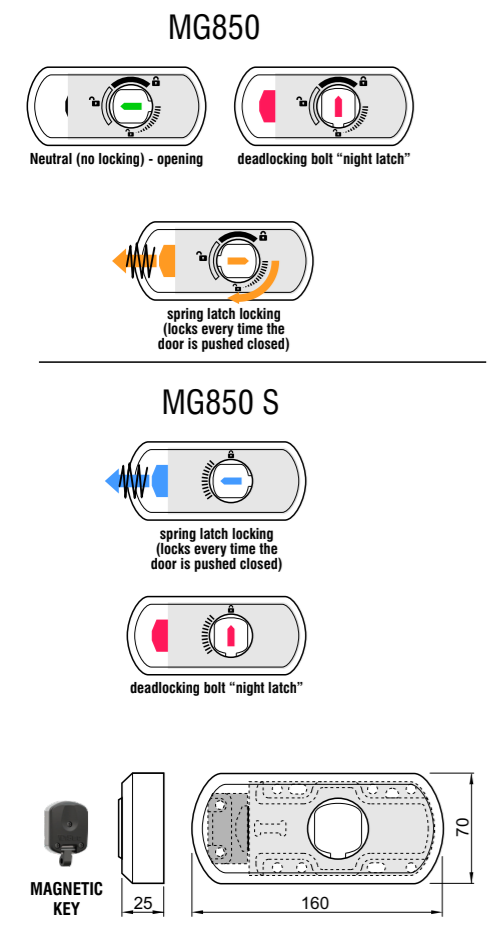

OPENING-CLOSING POSITIONS

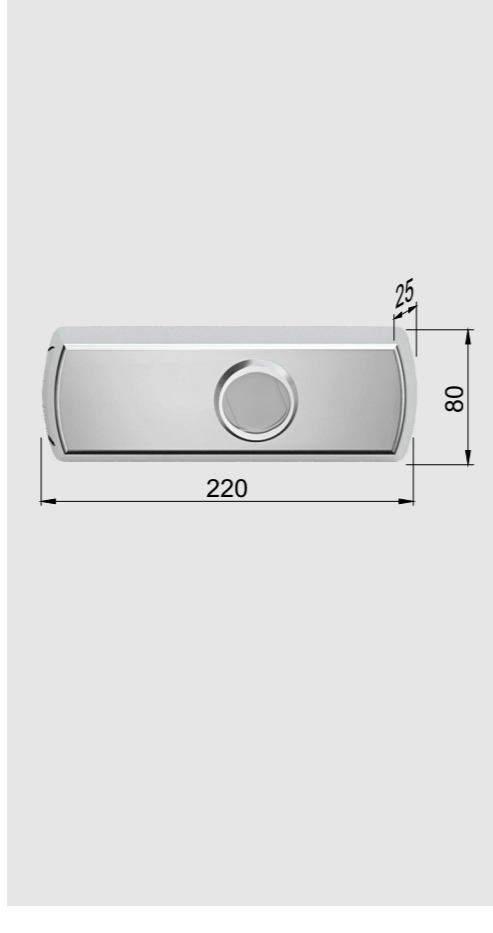

OPENING-CLOSING POSITIONS

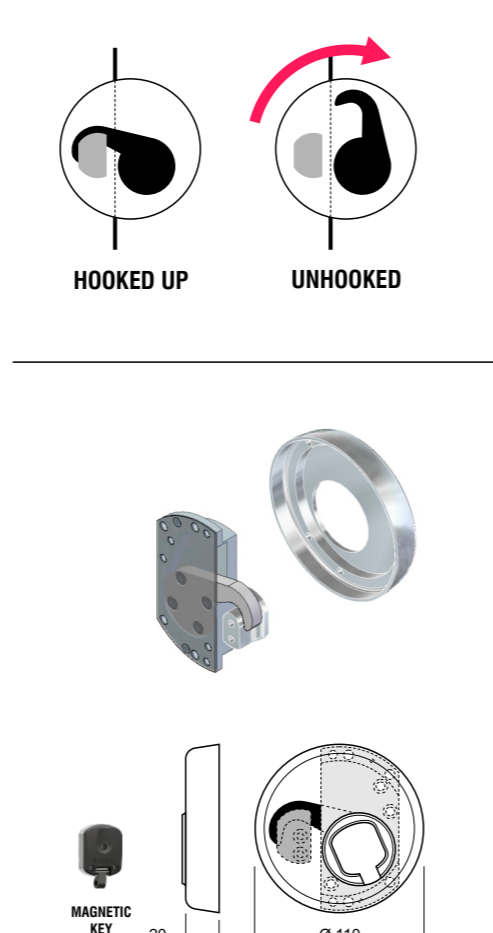

OPENING-CLOSING POSITIONS

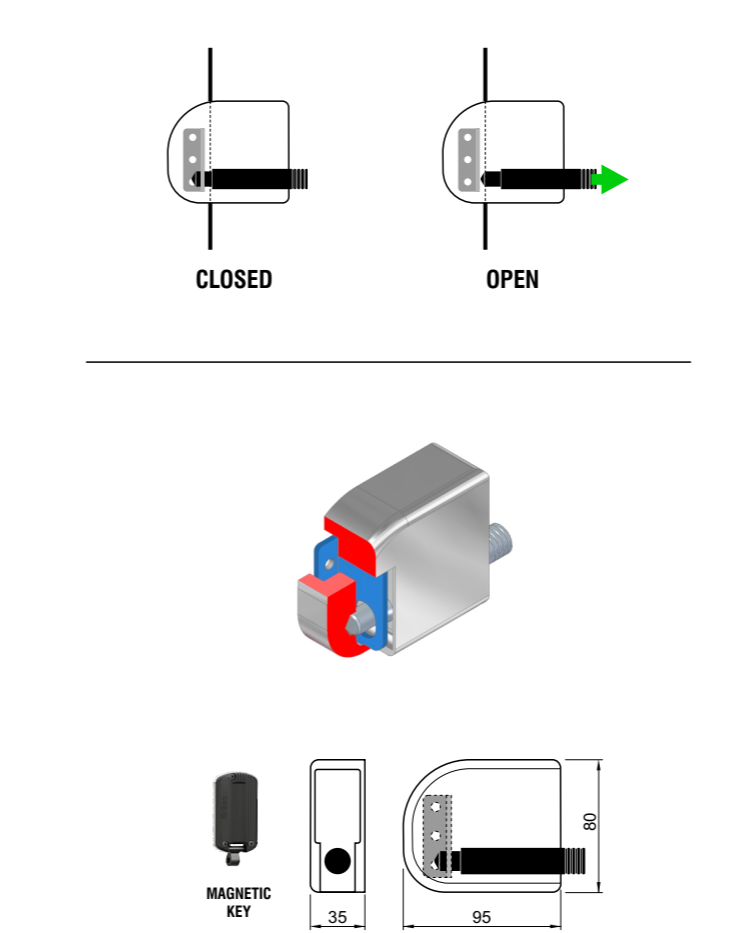

ALL ELECTRONIC DEVICES ARE ACTIVATED OR DEACTIVATED AUTOMATICALLY WITH A SPECIAL DISEC ID PROXIMITY DEVICE



WHEN THE OWNER IS ABSENT:
The **GPS LOCALIZER** checks up constantly the position of the vehicle. It creates a virtual boundary around the vehicle and if it moves off this "fence", it sends out an SMS warning with a link to "Google maps", where the coordinates of the van are displayed. It is therefore possible to track down the history of the movements of the vehicle, plus its present location on a smartphone. It also activate a direct line to a relay (Normally Open or Normally Closed). All the authorized telephones can at any time check for the whereabouts of the vehicle by just sending an SMS; the **GPS LOCALIZER** will answer indicating the position of the vehicle on a map.

WHEN THE OWNER IS PRESENT:
The **iD Proximity** device is detected, the protection system is de-activated and a relay line is opened. It is possible at any time to check on the position of the van via SMS.

ANTITAMPER ALARM
Available if connected to a **GPS LOCALIZER**
not available as a self-standing apparatus

WHEN THE OWNER IS ABSENT:
It detects if the Van protector is tampered. In case of a violent shock a warning SMS is sent out with a link to "Google maps" and the consequent coordinates of the vehicle on a smartphone.

WHEN THE OWNER IS PRESENT:
The **iD Proximity** device is detected, the protection system is deactivated and a relay line is opened. Available only for MG850/MG850 S. Available only if connected to a **GPS LOCALIZER**, not available as a stand-alone apparatus.