

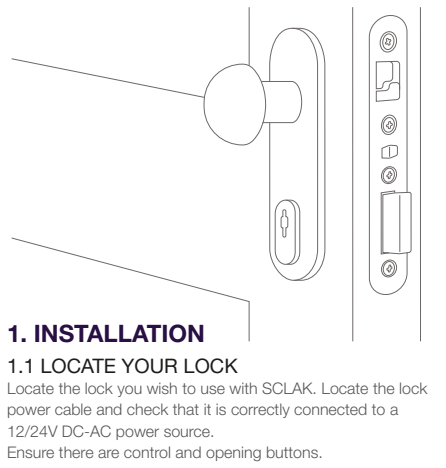

SCLAK Smarter and Safer Access

INSTALLATION MANUAL vol. 1.2

1. INSTALLATION
2. COMPATIBILITY
3. CABLES CONNECTION
4. TECHNICAL DATA
5. STANDARD CONFORMITY
6. PACKAGING RECICLYING



1. INSTALLATION

1.1 LOCATE YOUR LOCK

Locate the lock you wish to use with SCLAK. Locate the lock power cable and check that it is correctly connected to a 12/24V DC-AC power source.

Ensure there are control and opening buttons.

1xScrewdriver

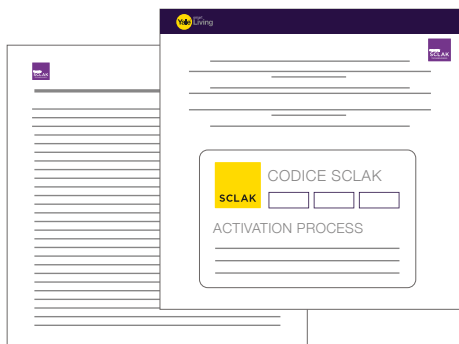
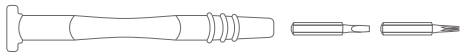

1.2. CHECK THE CONTENTS OF THE BOX

SCLAK unit, 4xT8 TORX screws for SCLAK unit, 2xseals, 1xJumper (possible to use with terminal boards), 2xWood screws, 2xIron screws, 2xWall plugs, 50cm power cable, Warranty, 1xDouble-sided adhesive, 2xWall plugs, 1xScrewdriver.

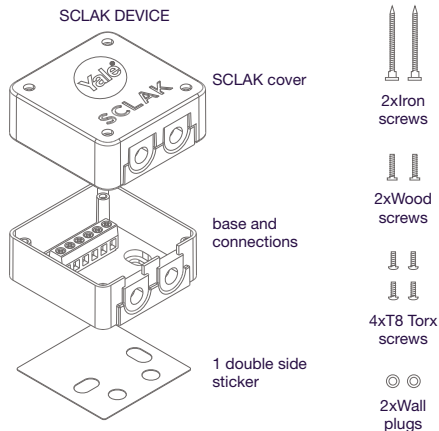

Activation code



1 jumper

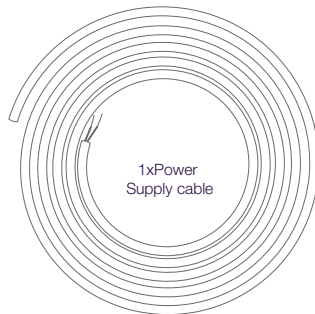

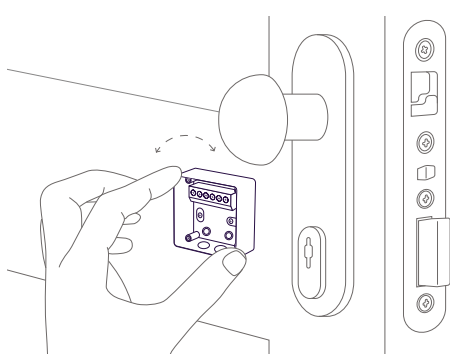

1.3. POSITION THE SCLAK UNIT

Place the SCLAK unit in the correct position for installation. For best results we recommend positioning the unit close to the existing lock. If this not possible, then position it close to the relevant switch.

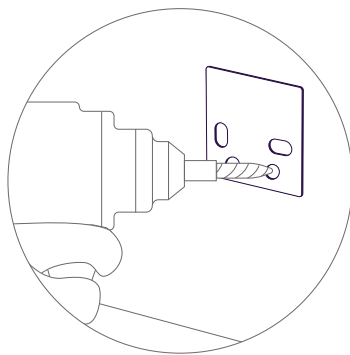

1.4. DRILL HOLES AND FIX THE UNIT

After positioning the SCLAK unit with the double-sided adhesive, drill holes to correctly fix the unit to the base. The base can be fixed to wooden or metal doorframes or to walls using the appropriate supplied screws.

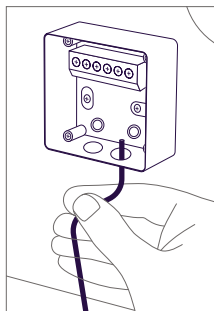

Fig.A

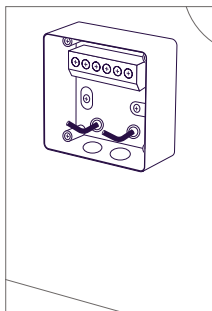

Fig.B

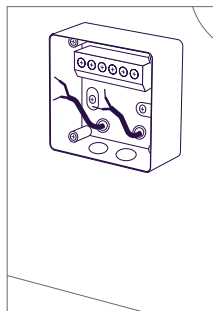

Fig.C

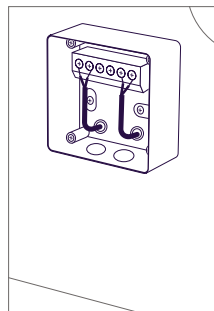

Fig.D

1.5. INSERT CABLES

The power and connection cables can now be inserted into the base either through the holes on the bottom side (Fig.A) or on the base of the SCLAK unit (Fig.B). Use the most appropriate holes.

1.6. CONNECT THE BASE

Connect the cables to the device connector using the above illustration (Fig.C and Fig.D). Check chapter 3 of this manual for more information about how to connect the cables. Please ensure the wires are correctly connected before proceeding with the test.

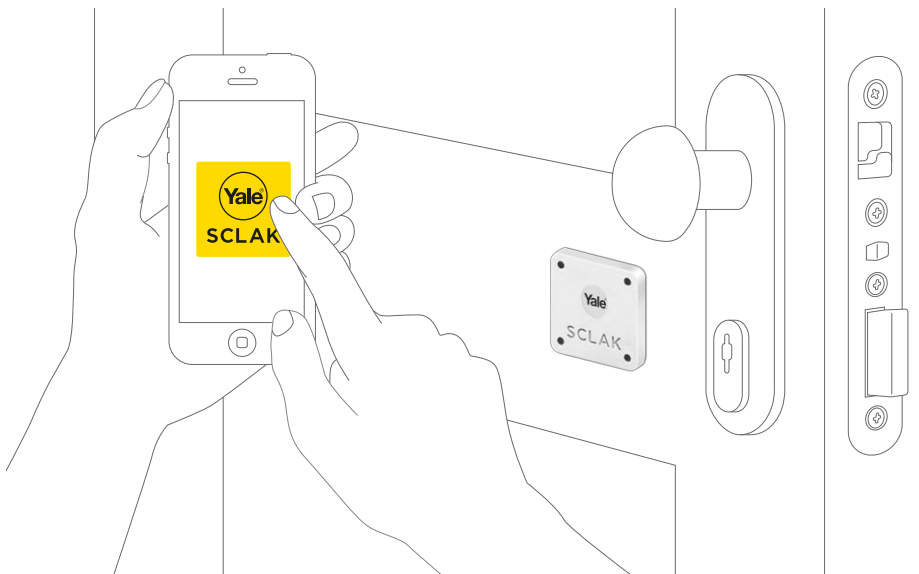

1.7. ACTIVATE SCLAK

Place the SCLAK cover over the base unit, ensuring that the contact pins are correctly connected. Check that the LED lights are working correctly and secure the unit with the 4 supplied screws.

2. COMPATIBILITY

SCLAK is compatible with every electric and elmech; it can be used with any existing opening systems, including traditional keys. It does not require an Internet connection.

It works with all smartphones with Bluetooth 4.0 running iOS 8 or above, Android 4.3 or above.



FOR MORE INFORMATION PLEASE VISIT
WWW.YALELOCK.COM

3. CABLES CONNECTION

Take the power supply cable out from the lock and connect it to SCLAK unit. Use extra power supply cable to connect SCLAK unit to the lock. Check the following cables connection options to connect your lock to SCLAK unit properly.

① STANDARD SCLAK CONNECTION

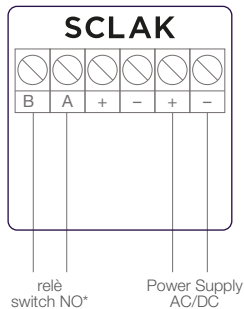

* Normally open contact

② ELECTRIC LOCK CONNECTION

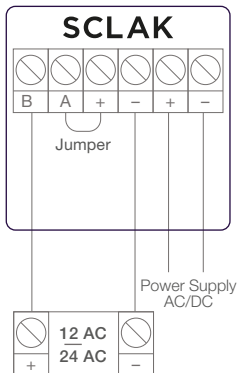

ELECTRIC LOCK

③ TYPICAL MOTORIZED LOCK/DOOR CONNECTION

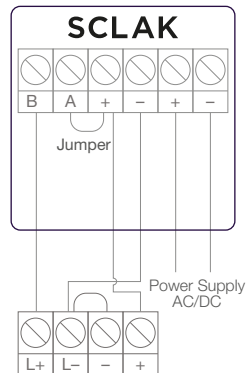

ELMECH LOCK ALWAYS POWERED

4. TECHNICAL FEATURES

DIMENSION	50x50x24 mm
POWER SUPPLY	AC-DC 12-24V (+ / - connectors)
ENERGY CONSUMPTION	Max 1W
CONTACTS	NO DRY CONTACTS (A,B connectors)
MAX OUTPUT	1A

CERTIFICATION	CE certified
OPERATING TEMPERATURE	-20 + 55° C
FREQUENCY	2.4 GHZ
PROTECTION	IP 44 If properly installed
CONNECTION	Bluetooth 4.1 BT

5. STANDARD CONFORMITY

DECLARATION OF CONFORMITY TO 1999/5/CE DIRECTIVE



Yale® is authorized to use CE mark on SCLAK product to declare its conformity to 1999/5/CE directive.



EU/EFTA member states

All EU/EFTA state members



All EU/EFTA states memeber with use limitation

None

6. PACKAGING RECYCLING

PRODUCT PACKAGING CAN BE RECYCLED. PACKAGING AND PRODUCTS DISPOSAL NEED TO FOLLOW RELATED LAWS ON THE DIFFERENT COUNTRIES.



The product can't be disposed together with other domestic waste.
Please contact your local environment agency to know how to dispose electric and electronic products.



The packaging can be recycled according to the recycling process available in your country.



SCLAK is RoHS conforme.

LIMITED WARRANTY

Yale® hereby warrants, to the end user ("Purchaser") who purchased the genuine Yale® product ("Product"), from an authorized Yale® dealer ("Dealer"), that the Product will be free from defects in materials and workmanship ("Defects"), for a period of two year from the date the Product was purchased from Yale®'s authorized dealer. Subject to the terms and conditions indicated below, Yale® will repair or replace such Product or part thereof which, upon inspection by Yale®'s authorized dealer, is found to be defective, despite the Product not having been subjected to Improper Activity (as defined below). Improper Activity shall render this warranty void. "Improper Activity" includes any and all of the following: installation by anyone other than a Dealer: improper installation; use/operation/maintenance other than in accordance with Yale®'s instructions and requirements (as directed below); tampering by Purchaser; neglect; damage by the application of force; bending; breaks; cracks; scratches; any other act of vandalism; repair or alteration by anyone other than a Dealer: approved batteries, accessories and/or other components that are not suitable and genuine Yale® products; all the foregoing as determined by Yale®, in its sole judgment. Yale®'s sole obligation under this limited warranty is to repair or replace, at Yale®'s sole discretion, at the venue of a Dealer, any Product and/or Product component found by Yale® to have Defects. This limited warranty does not grant any other rights or give rise to any other obligation, or absolve Purchaser of the responsibility to employ any other suitable measures, by whatever means, including insurance, against the risk of personal injury or damage to property. This limited warranty relate to product's defects only. Yale® shall be liable, in any event, for any labour costs associated with the product and its installation process. In order to facilitate the warranty service and enable Yale® to determine entitlement under this warranty, Purchaser must first return the Product, with proof of purchase from a Dealer, to Yale®, either directly, or through the Dealer from whom Purchaser purchased the Product. All shipping, handling, travel, service call and/ or other incidental and/or related charges are fully payable by Purchaser only and are not included in this limited warranty.

THE USE OF OTHER THAN SUITABLE, GENUINE YALE® COMPONENTS MAY CAUSE SEVERE DAMAGE TO THE PRODUCT, AND WILL VOID THIS LIMITED WARRANTY. THIS LIMITED WARRANTY MAY NOT BE ASSIGNED OR OTHERWISE TRANSFERRED IN ANY WAY AND MAY NOT BE EXTENDED, ALTERED OR VARIED. TO THE FULLEST EXTENT ALLOWABLE BY THE LAWS APPLYING HERETO, THIS LIMITED WARRANTY IS IN LIEU OF ANY OTHER WARRANTIES, EITHER EXPRESS OR IMPLIED, INCLUDING BUT NOT LIMITED TO ANY WARRANTIES OF MERCHANTABILITY OR FITNESS FOR A PARTICULAR PURPOSE, ALL OF WHICH ARE EXPRESSLY EXCLUDED AND DISCLAIMED. YALE® WILL NOT BE LIABLE FOR LOSS OF PROFITS, ANY SPECIAL, INCIDENTAL, OR CONSEQUENTIAL DAMAGES, WHICH PURCHASER MAY SUSTAIN, OR PUNITIVE DAMAGES, EVEN IN THE EVENT OF NOTICE OF THE POSSIBILITY OF SUCH DAMAGES.

ASSA ABLOY Italia S.p.A.
Tel.: +39 051 6812411
Fax: +39 051 827486

info@assaabloy.it
www.assaabloy.it